

## MA5B2IE3

Squirrel cage asynchronous motor  
Type of motor IEC 132S-2 IE3

GU

2 poles - frame 132S - 5,5kW - 400/690V - 50Hz - Aluminium - IE3

ELECTRICAL DATA		
Rated motor voltage	V	400/690
Rated frequency	Hz	50
Rated motor power	kW	5,5
Rated motor speed	rpm	2900
Rated motor current	A	10,11 / 5,84
Starting/Rated current (Is/In)		7,5
Rated torque	Nm	18
Starting/Rated torque (Ts/Tn)		2,3
Breakdown/Rated torque (Tmax/Tn)		2,2
Efficiency at 100%	%	89,2
Power factor at 100%		0,88

MECHANICAL DATA		
Balancing		Half Key
Bearing DE		6308ZZ
Bearing NDE		6308ZZ
Lubricant type		N/A

GENERAL DATA		
Frame size	mm	132
Type of mounting		B3
Weight	kg	45
Degree of protection		IP55
Method of cooling		IC411
Material of housing		Aluminium
Terminal box		See drawings / TOP
Insulation class - Temperature class		F/B 80K DOL F/F 105K in VSD S9 (35 - 50Hz)
Duty type		S1
Paint Ral n°		5003
Direction of rotation		Clockwise/Counterclockwise
Noise @ 1m	dB (A)	80
Inertia rotor	kgm <sup>2</sup>	0,0377
Vibration class		Class B
Shaft diameter	mm	38

SITE CONDITIONS		
Ambient temperature	°C	-20 - +40°C
Altitude above sea level	m	0-1000m

SITE CONDITIONS		
3 x PTC 150°C Windings		included

STANDARDS		
Specification: IEC 60034-1	Vibration: IEC 60034-14	
Tests: IEC 60034-2	Tolerance: IEC 60034-1	
Noise: IEC 60034-9		

The rating plate values can be different from the calculated values: Data subject to changes.

Focquet 2022

This document is exclusive property of FOCQUET SA. Reprinting is not allowed without written authorization.

Focquet  
DEPUIS 1892 - SINDS 1892



ISO 9001 :2015  
N° : 44.100.150657

Rue des Haïpes 1  
5030 Gembloux - Belgium  
TEL +32 (0) 81 62 59 70

info@focquet.be  
www.focquet.be

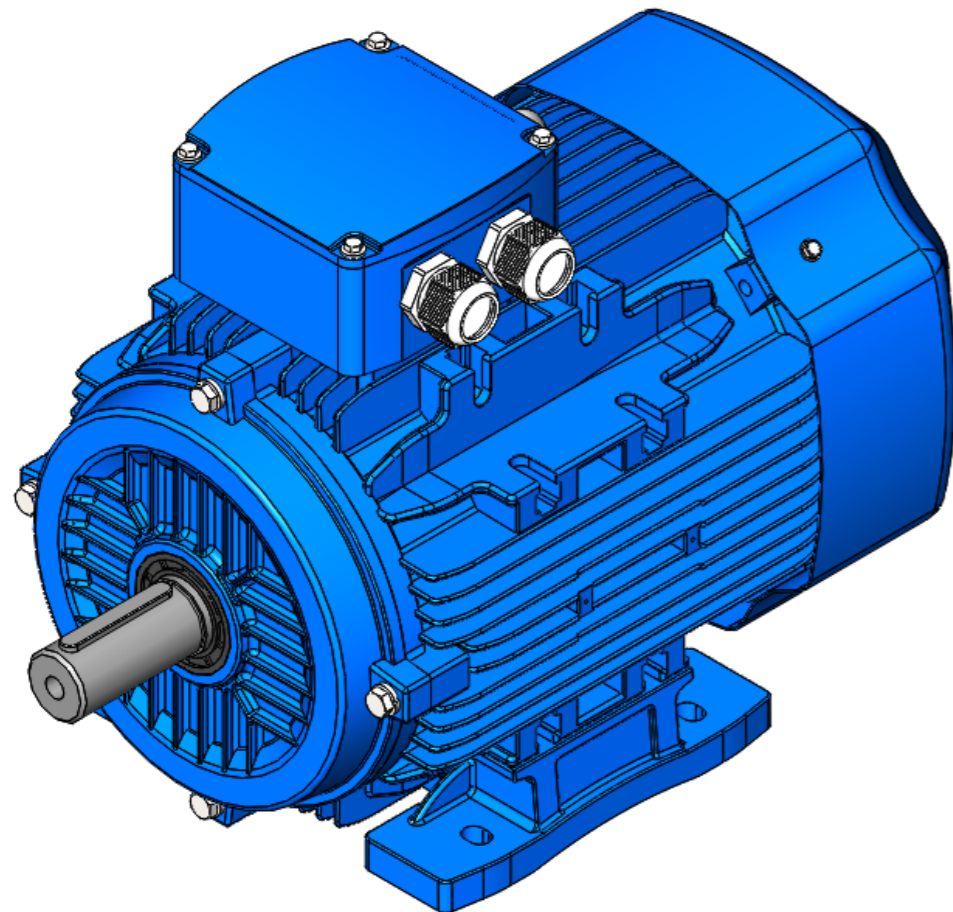
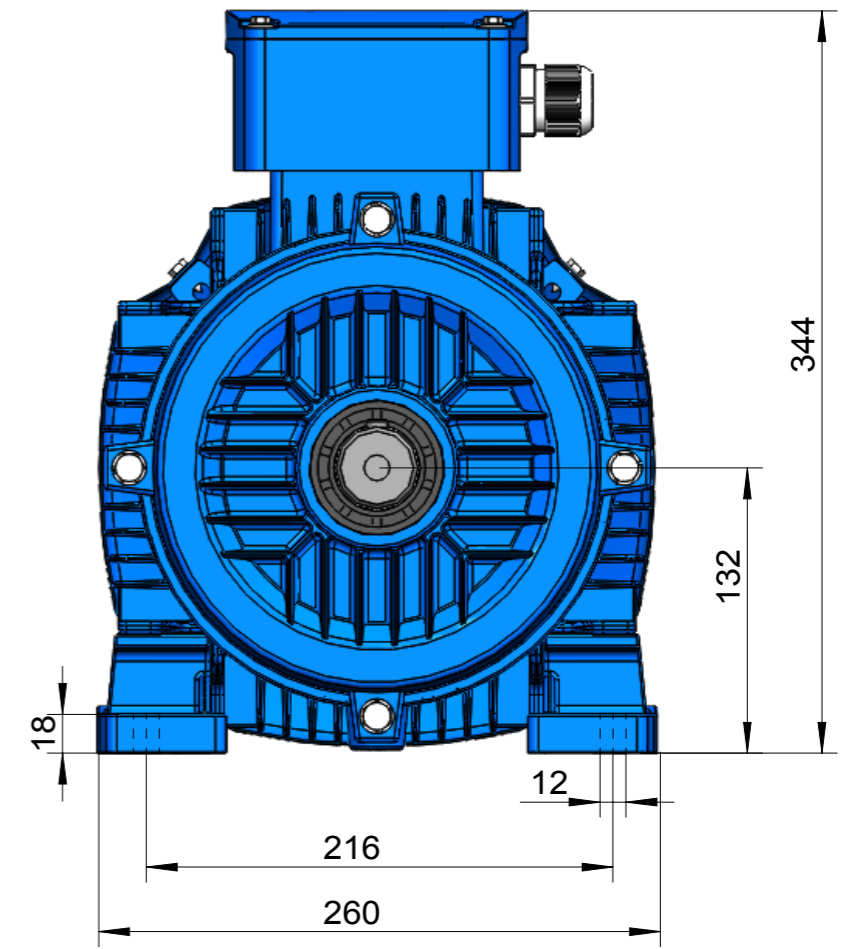
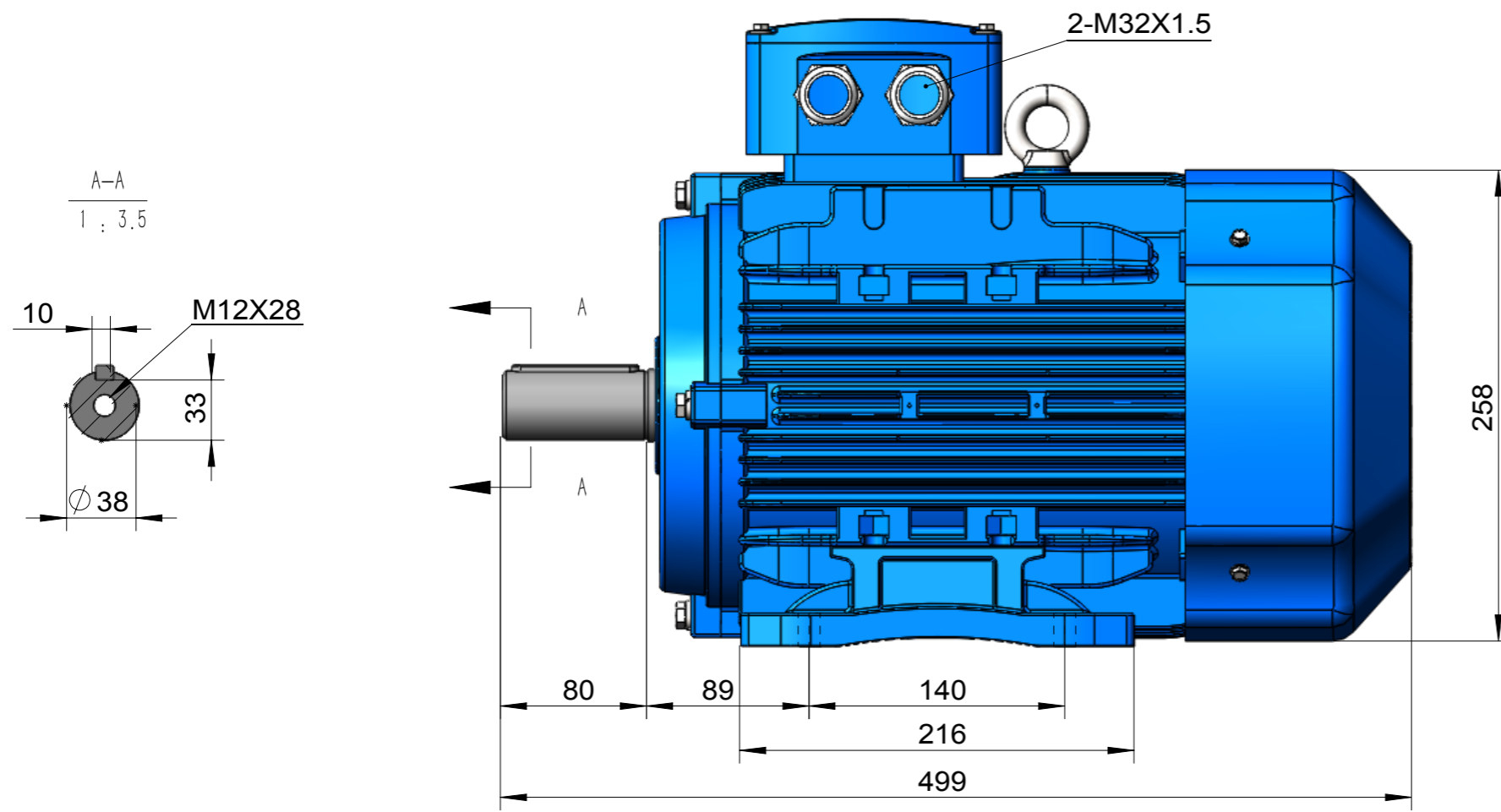

IE3-132S-B3  
Mounting diagram